

# MULTIPANEL Balcony Substrate Waterproofing System

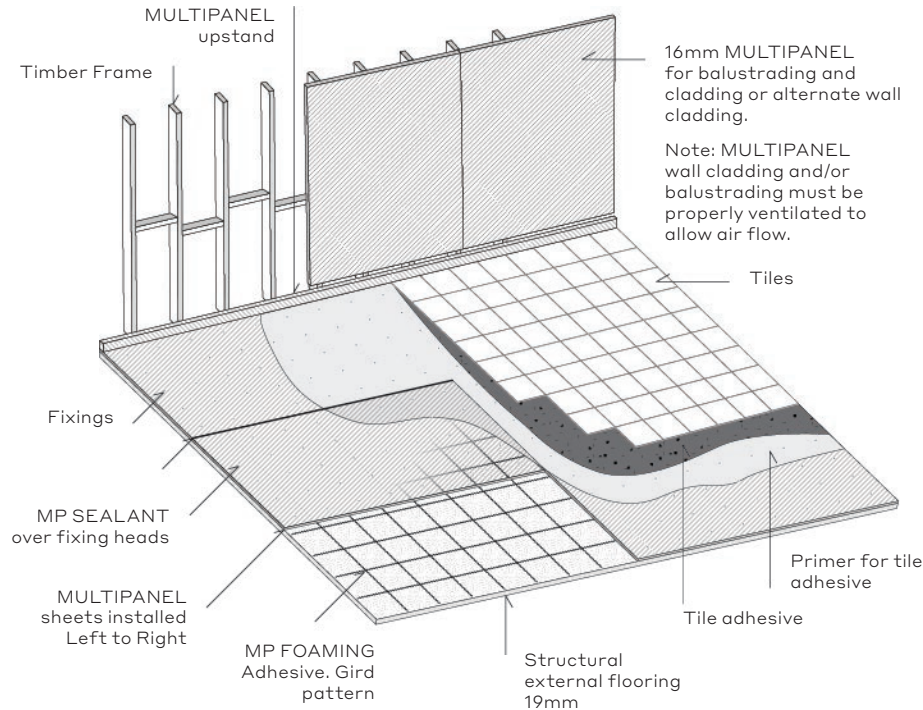

## Product Analysis



## What is MULTIPANEL?

MULTIPANEL manufactures a revolutionary, high-density, polyurethane composite building panel, ideal for waterproofing bathrooms and wet areas as it is lightweight, 100% waterproof, highly versatile and replaces the need for a liquid membrane.

This innovative product is currently the most technologically advanced construction panel on the global market. It is a significantly superior alternate to traditional building materials.

### PRODUCT ADVANTAGES

- / Lightweight
- / 100% waterproof
- / Eco-Friendly
- / Labour Saving
- / Insulating

Product	Waterproof	Lightweight	Joist spacing	Ease of construction	Labour installed in 4hrs
<b>15mm Compressed FC</b> 2400 x 1200 x 15mm Approx. 86Kg Per Sheet	NO	NO	450mm	NO Pre-drilling required, very heavy, labour intensive, requires a membrane	8.4 M <sup>2</sup> 3 Sheets
<b>19mm Tongue &amp; Groove Cement Sheet</b> 2700 x 600 x 19mm Approx. 40Kg Per Sheet	NO	NO 25Kg M <sup>2</sup>	450mm	NO Heavy, requires 2 men to lift, requires a membrane	8.4 M <sup>2</sup> 10 Sheets
<b>MULTIPANEL</b> 2400 x 1200 x 30mm 18Kg Per Sheet	YES	YES 6.2Kg M <sup>2</sup>	300mm	YES Approx. 76% Lighter <b>NO MEMBRANE REQUIRED</b>	40 M <sup>2</sup> 14 Sheets

## Independent Product Cost Analysis by the Meccano Group

Product	(\$ ) Material per M <sup>2</sup>	(\$ ) Adhesives per M <sup>2</sup>	(\$ ) Labour per M <sup>2</sup>	(\$ ) Membrane per M <sup>2</sup>	(\$ ) Total per M <sup>2</sup>
15mm Compressed FC	55.0	5.0	60.0	40.0	160.0
19mm Tongue & Groove Cement Sheet	60.0	5.0	28.0	40.0	133.0
<b>MULTIPANEL</b>	<b>95.0</b>	<b>5.0</b>	<b>18.0</b>	-	<b>118.0</b>

Cost analysis based on 2 men working 4 hours at \$60 per hour each.  
The prices stated above are to be used as a guide only, as there are many factors that can alter the final price.

## Product Advantages

# Lightweight

A 2400 x 1200mm panel weights only 18kg (6.25Kg M2).

# 100% Waterproof

No need for any costly membranes over MULTIPANEL as it is totally waterproof.

# Eco-Friendly

Independently verified by EcoSpecifier with no VOC emissions.

# Labor saving

All edges of the panel are tongue & grooved for installation convenience. MULTIPANEL can be installed up to 75% faster than alternative balcony systems.

# Insulating

The 30mm MULTIPANEL has an "R" rating of 1.11 (M2-K/W).

# MULTIPANEL



**MULTIPANEL Pty Ltd**

Phone +61 3 9787 2544

Email [info@multipanel.com.au](mailto:info@multipanel.com.au)

[multipanel.com.au](http://multipanel.com.au)

